



THIS SHEET IS INTENDED TO BE REPRODUCED AT 20X20. REPRODUCTION OF THIS SHEET AT A DIFFERENT SIZE THAN INTENDED SHALL VOID THE SCALE SHOWN ON THE SHEET.

LEGEND	
	PROPOSED 100% PMF FLOODPLAIN
	EXISTING NORMAL POOL ELEVATION 1295.5
	PROPOSED NORMAL POOL ELEVATION 1291.5

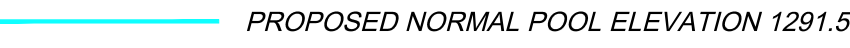
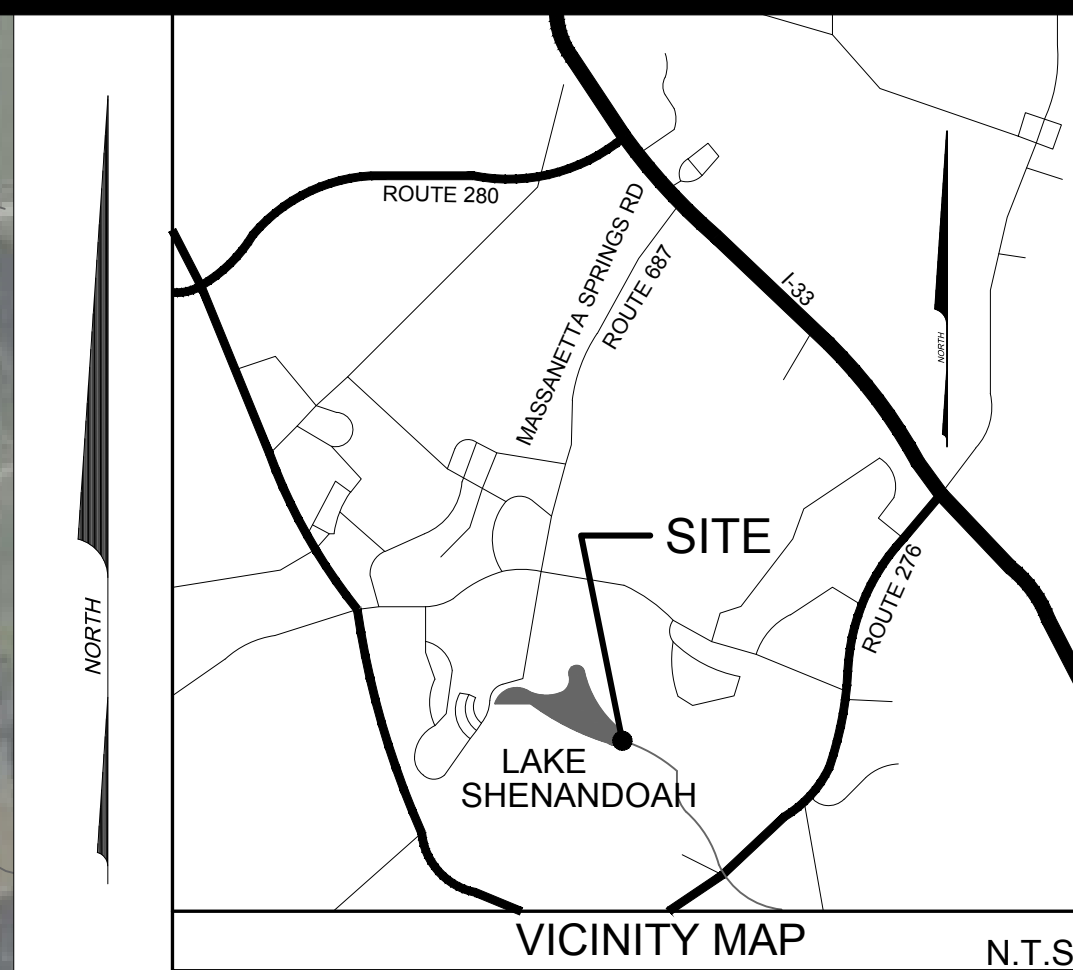

HURT & PROFFITT
INSPIRED / RESPONSIVE / TRUSTED

434.847.7796
2524 LANGHORNE ROAD
LYNCHBURG, VA 24501

HP
HURTPROFFIT.COM
ENGINEERING • SURVEYING • LAND DEVELOPMENT • ENVIRONMENTAL
GEO-TECHNICAL • CONSTRUCTION TESTING & INSPECTION • CULTURAL RESOURCES



- EXISTING POOL ELEVATION 1290.58
- PROPOSED NORMAL POOL DAM 1291.5
- NORMAL POOL EXISTING DAM 1295.5
- PROPOSED 100% PMF FLOODPLAIN (POST - 2015 RAINFALL DATA) SPILLWAY DESIGN FLOOD ELEV. 1297.47

LAKE SHENANDOAH
VA 165005

PROPOSED DAM

EXISTING TOP OF DAM ELEV. 1301

LAKE SHENANDOAH DAM	
EXISTING	
NORMAL POOL ELEVATION:	1295.5'
AUXILIARY SPILLWAY ELEVATION:	1296.0'
TOP OF DAM:	1301.0'
NORMAL POOL AREA:	38.39 ACRES
NORMAL WATER DEPTH AT DAM:	19.5 FT
PROPOSED	
NORMAL POOL ELEVATION:	1291.5'
TOP OF DAM:	1298.0'
NORMAL POOL AREA:	26.95 ACRES
NORMAL WATER DEPTH AT DAM:	15.5 FT

PROPOSED DAM TOP LOWERING
FOR
LAKE SHENANDOAH DAM
ROCKINGHAM COUNTY, VIRGINIA

PROJECT NO.	20191817
FILE NO.	20191817
LAT.	38.379099°
LONG.	-78.832572°
DATE:	10/25/2023
DRAWN BY:	MSF
CHECKED BY:	MDW

EXHIBIT

HURT & PROFFITT	
SHEET NO.	REV.
1 OF 2	

Oct 26, 2023 - 11:17am, Z:\2019\20191817\Engineering\CAD\191817_DWR\EXHIBITS.dwg